

GATHERINGS AT EAST GREENWICH INCLUDED FEATURES



COMMUNITY AMENITIES

- Active Adult Single Family Homes
- Clubhouse with swimming pool, tennis courts, bocce courts, walking trails, gazebos, walking trails, and aerated pond
- Landscape package with fully sodded lawns and sprinkler-system
- Public water and sewer with Underground Utilities
- Asphalt Driveways
- Tree-Lined Streets
- Sidewalks with Belgian block curbing and mail boxes

MAGNIFICENT KITCHEN DESIGNS

- Distinctive state-of-the-art designs and amenities
- 42" Custom-crafted oak cabinetry
- Laminated countertops in a wide choice of colors
- Whirlpool® gas range and self-cleaning oven
- Whirlpool® under cabinet microwave oven
- Whirlpool® insulated Dishwasher
- No-wax vinyl flooring in a variety of colors
- Stainless steel kitchen sink with chrome Moen® faucet and sprayer
- Recessed light over the kitchen sink
- Center Island or peninsula where shown on plan

INTERIOR APPOINTMENTS

- 9' first floor ceilings in all models
- Plush wall-to-wall carpeting in a wide choice of colors
- Distinctive colonial six-panel interior doors with traditional colonial trim
- Abundant closet space with vinyl-coated ventilated shelving
- Laundry Room with hook-ups for washer and gas dryer
- Hard wired smoke alarms (with battery back-up) on each living level and in each bedroom
- Cathedral and coffered ceilings (where applicable per plan)
- Oak hardwood floor in foyer

LUXURIOUS BATHROOMS

- Lavish Owner's Bath with one piece shower enclosure with seat and frosted shower door
- Owner's and hall bath with cultured marble vanity tops in choice of colors with oak vanities and chrome Moen® faucets
- 12" x 12" ceramic floor tile in all baths

COMPLETE CARE & COMMITMENT TEAM

- New Home Counselors & Builders will lead you through the home buying process
- Elaborate Design Studio with professional Design Staff
- Customer Care Department

eSMART™ ENERGY-SAVING DESIGN

Energy Star® Qualified Homes

- Gas hot air heating system
- 14.5 SEER Central air conditioning with R410A Refrigerant
- 50-Gallon gas-fired water heater
- Tyvek house wrap to reduce air filtration, air barrier sealing
- Insulated double-pane Low-E glass single hung windows with grills and screens with tilt-in lower sash
- Water saving plumbing fixtures
- High efficiency Merv-8 HVAC filter
- Low VOC emission Paint and carpet
- Honeywell programmable thermostat
- CFL light bulbs
- Home energy Monitor
- 200-AMP Electrical service
- Fully insulated (R-38) ceilings and (R-15) exterior walls
- Duct blaster and Blower door efficiency testing
- HERS 3rd party independent energy inspections
- Advanced framing techniques

EXCEPTIONAL FEATURES

- Maintenance-free vinyl siding
- Maintenance-free aluminum wrapped exterior trim & ventilated vinyl soffits
- Seamless aluminum gutters & leaders
- Two frost-free hose bibs
- Front and rear waterproof exterior outlets
- Copper electric wiring throughout
- Lever handle front door hardware with dead-bolt
- Two CAT-5 phone jacks and two RG6 cable outlets
- Two car garage with standard opener
- Self-sealing asphalt roof shingle with a 30-year warranty

QUALITY ASSURANCE

- 10-year structural warranty/insured program through Professional Warranty Corporation
- Beazer Customer Satisfaction Program - Pre construction meeting, Pre drywall meeting, Pre settlement orientation

The above information is subject to change without notice.

5/25/11



GATHERINGS AT EAST GREENWICH COMMUNITY SITE PLAN

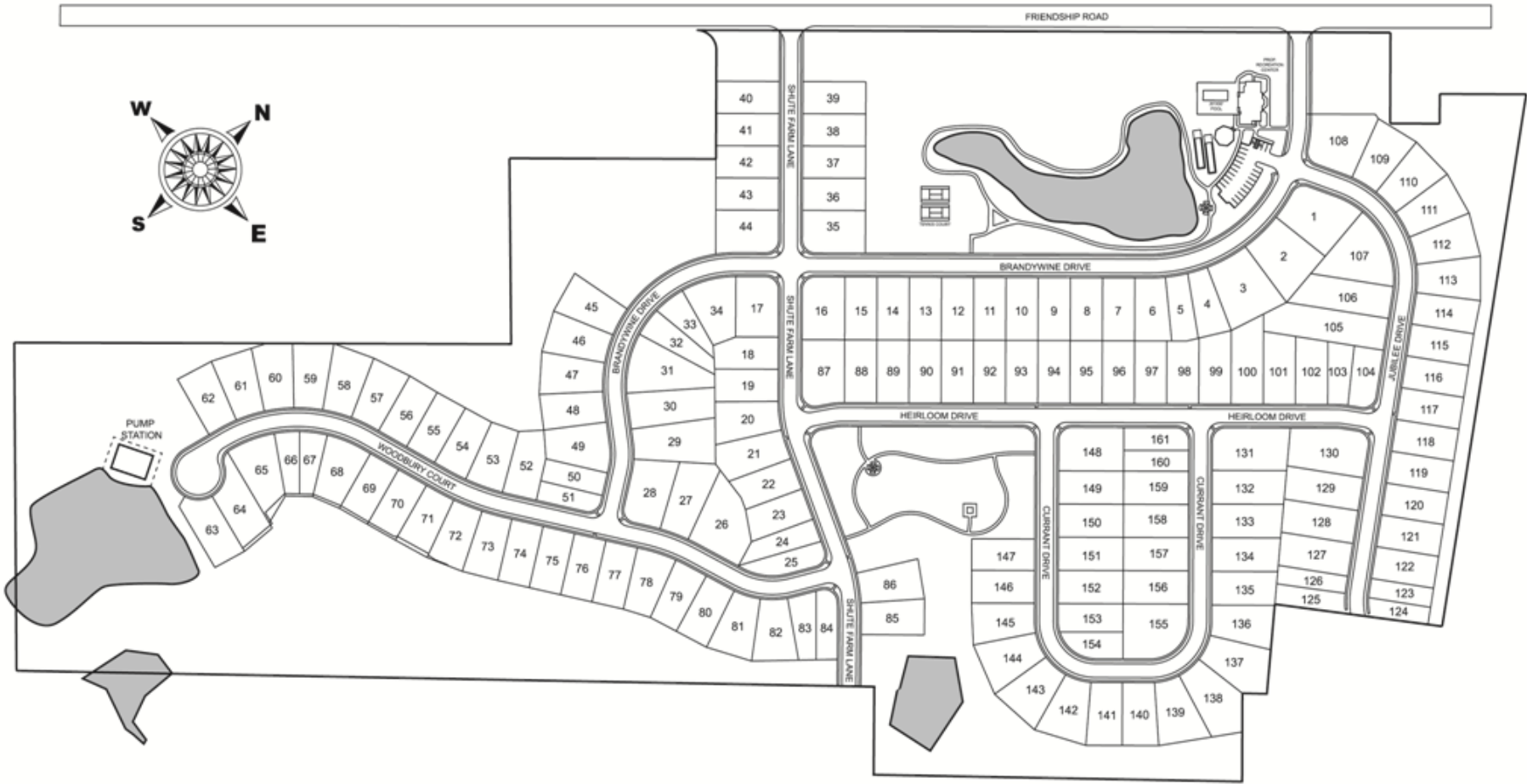

Note: Homesites are approximate. Easements and other conditions are not shown on this plan. Refer to approved engineering plans for homesite specific information. Not responsible for errors or omissions. Subject to change without notice.